

- EXIST NEW
- IDS SECURE CONTROL PANEL
 - PASSIVE INFRARED MOTION DETECTOR, 360 DEG
 - DURESS BUTTON
 - BMS
 - ELECTRICAL POWER PANEL
 - WALL PENETRATION
 - KEY PAD
 - 200x200 PULL BOX

1. MISCELLANEOUS NOTES
- A. CONDUITS:
- 1) ABOVE GROUND EXTERIOR LOCATION: GALVANIZED RIGID CONDUIT, UNLESS NOTED OTHERWISE.
 - 2) NO MORE THAN TWO 90 DEGREE OR TOTAL 180 DEGREE BENDS BETWEEN PULL POINTS.
 - 3) PROVIDE INSULATED BUSHINGS AT ALL TELECOMMUNICATIONS CONDUIT TERMINATIONS AT ALL BOXES AND CONDUIT STUBS.
- B. PULLBOXES:
- 1) PULL BOXES SHALL BE STEEL.
- C. REPAIR ANY DAMAGE TO EXISTING CONSTRUCTION RESULTING FROM THE INSTALLATION OF TELECOMMUNICATION ITEMS. THE AREAS REPAIRED SHALL MATCH THE ADJACENT SURFACES IN TEXTURE AND COLOR.
- D. ELECTRICAL
- PANEL "L8"
CIRCUIT NUMBER #31 ~~#33~~

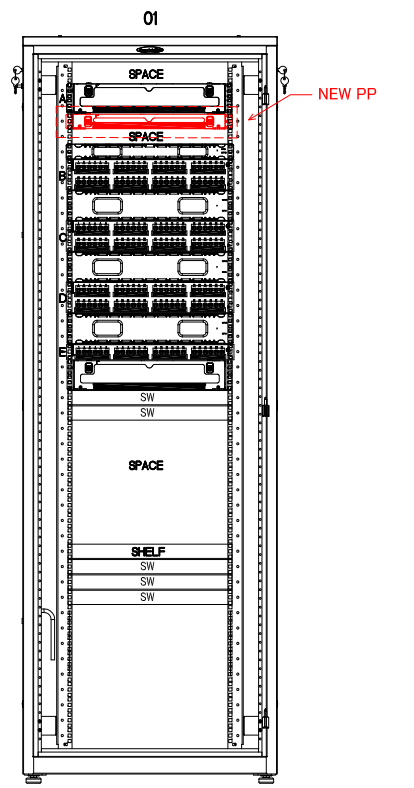

#1
ROOM #501
COMM I
NEW FIBER PP 6SM/SC

AS-BUILT

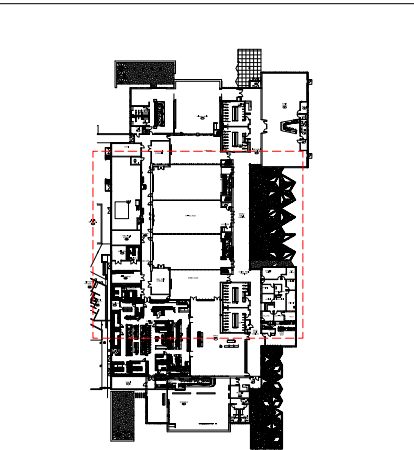

KEY PLAN - BLDG 622
NOT TO SCALE

REVISION	DATE	DESCRIPTION	APPROVED
AMERICAN ENGINEERING CORP. P.O. BOX 131 GINOWAN OKINAWA TEL 098-897-6781-4		PROJECT NUMBER	
KADENA AIR BASE		OKINAWA, JAPAN	
Install IDS infrastructure for Vault Rm. at Rocker NCO, KAB			
NEW IDS PLANS			
DRAWN BY KIWAKO	CHECKED BY JOHNNY HAHN	ENGR TORU GUSHIKEN	AEC NO. 1578
SUBMITTED BY REPRESENTATIVE OF CONTRACTOR		APPROVED BY	
SCALE	NOT TO SCALE	DATE	05 JUNE, 2018
DWG NO.	1	OF	1